

## Activity 1:

# Roles and responsibilities: the conservation and management of change of Listed Buildings



Read through the following scenario that is drawn from a real-life proposal to convert a Grade II listed Church into an Indoor Climbing Centre and Café.

Once you have read through the information, complete the activity sheet that has been provided.

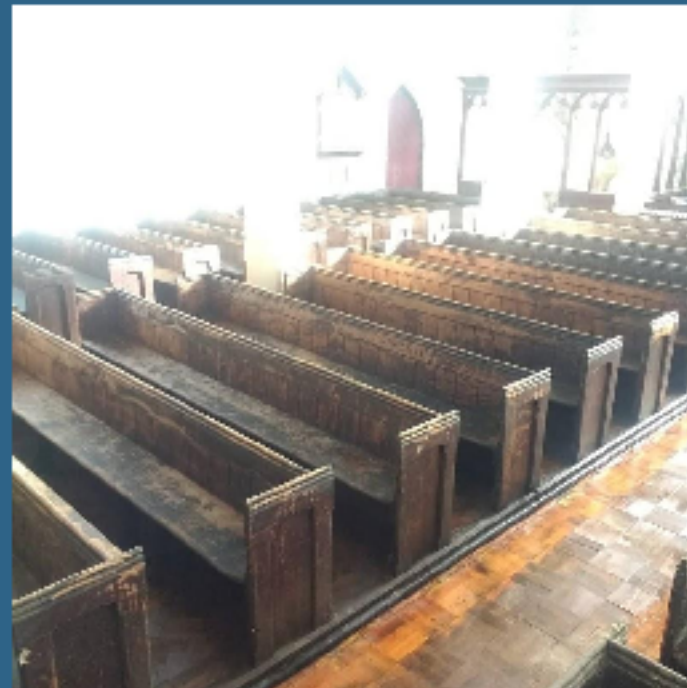



# The Background and history

The main reason for building a new church in Carmarthen in 1837 was to enable more services to be held in the Welsh language, and to attract residents who would otherwise attend nonconformist chapels

The church was severely damaged during storms in 2003 which saw 65 tonnes of stone crashing through the ceiling and the weather wreaked havoc inside. This led to the closure of the Church

## Church which sold for just £1 is back on the market

The church has retained its stained glass windows, impressive pillars and font



The Church is Grade II listed and is within a Conservation Area. It was listed in 1981 and was amended in 2003

December 2015 a charity was set up for the Preservation, Upkeep, & Maintenance of the historic Cemetery associated with the Church

In 2011, the building was sold for £1. The new owner failed to get permission to convert the church into a 4 bedroom dwelling.

# SUMMARY OF THE PROPOSAL

Maintaining an open plan arrangement where possible

Font and surrounding screen, built in seating and pulpit to be retained

Stained glass windows to be repaired and retained

Organ and pews to be removed.

Climbing walls constructed of treated plywood supported on engineered, self supporting Scaffolding erected and braced around existing columns and walls- protecting existing structure.

Current openings and the exterior would remain unchanged.

Parking area to be constructed for 27 spaces

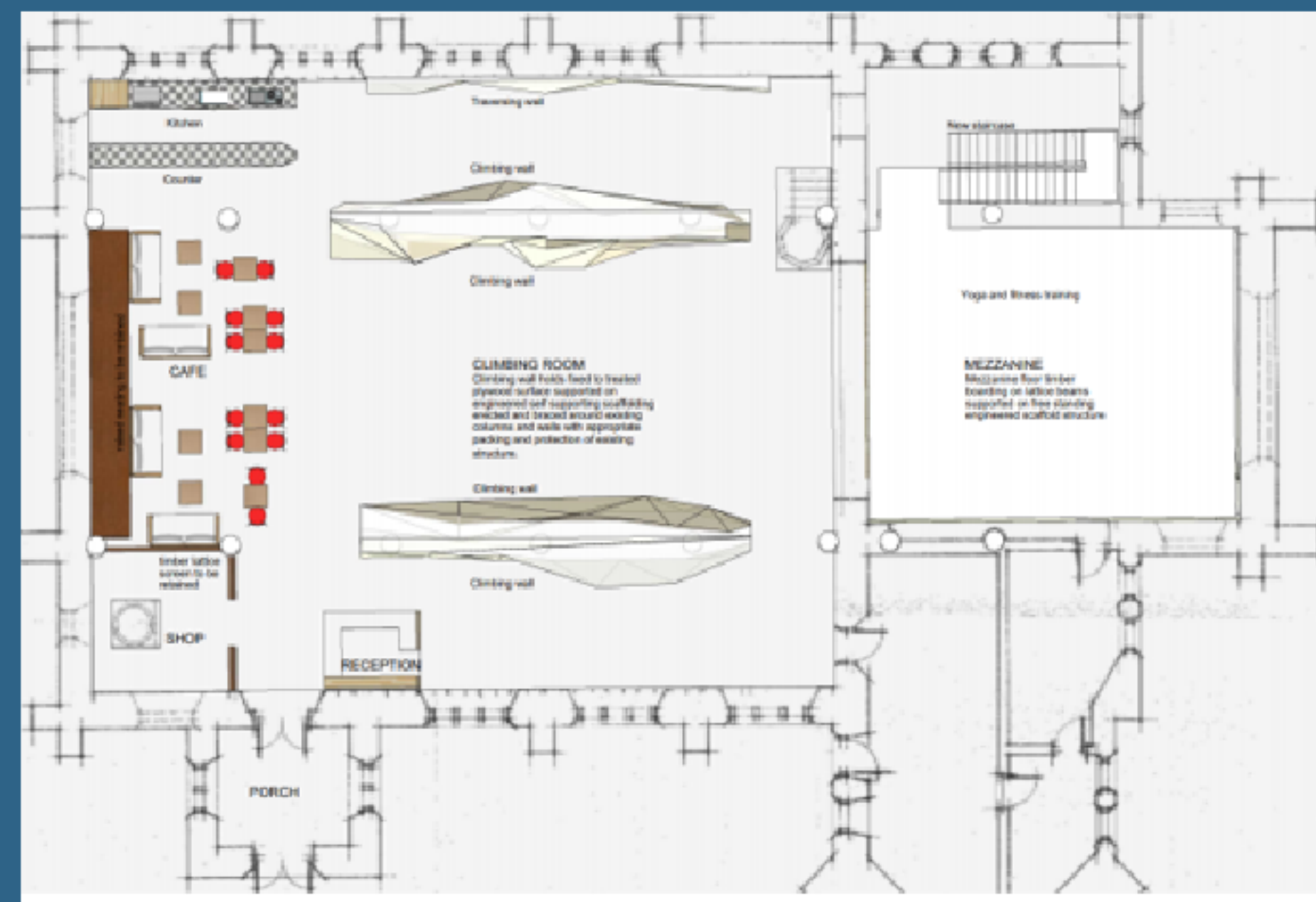

Proposed layout

Existing layout

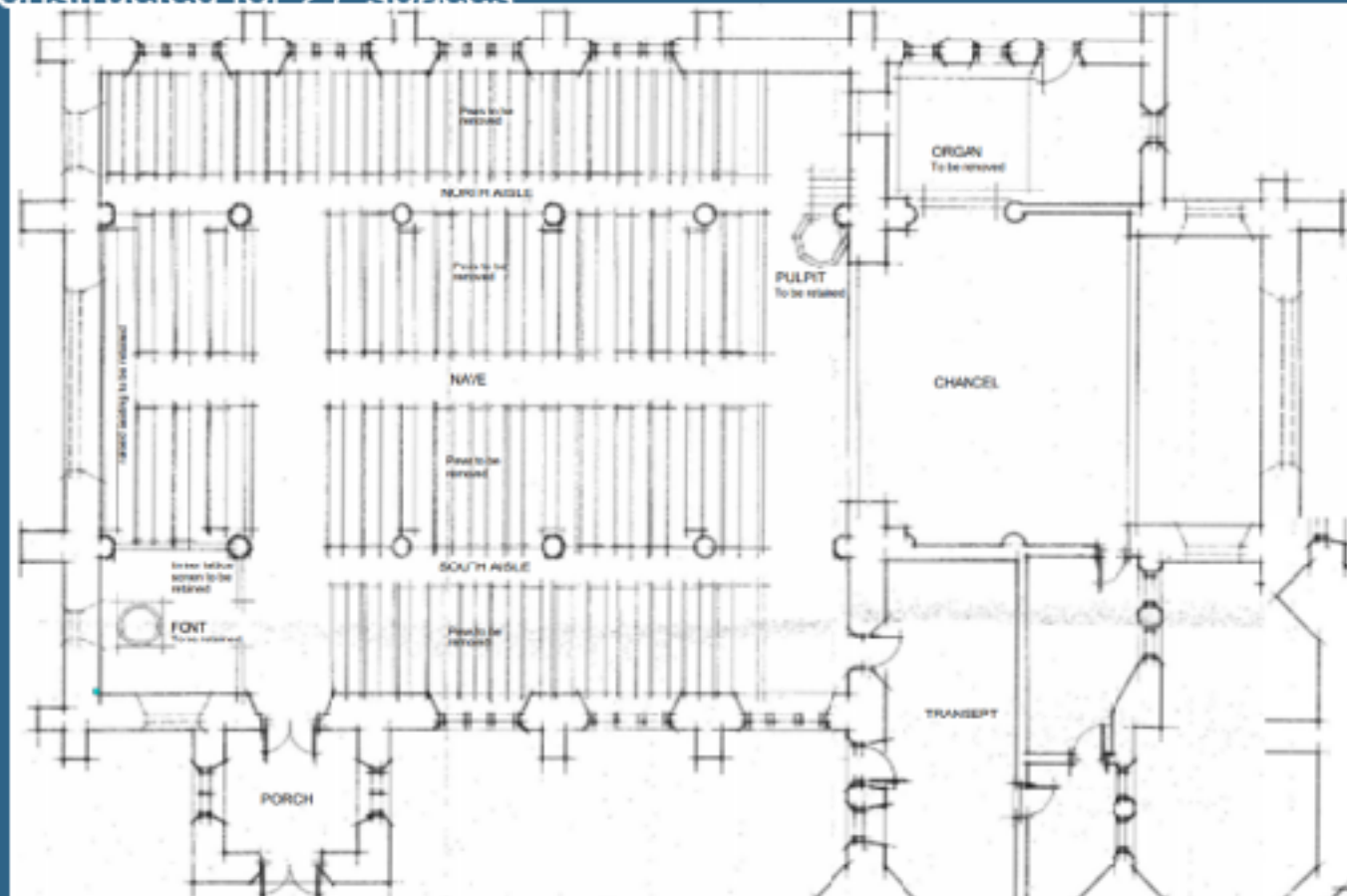



Listed below is a range of people who may be involved in the decision making process

PLANNING  
OFFICER

CONSERVATION  
OFFICER

BUILDING CONTROL  
OFFICER

REGENERATION  
OFFICER

ARCHITECT

LOCAL  
COMMUNITY

PLANNING  
ARCHAEOLOGIST

PLANNING  
ECOLOGIST

HIGHWAYS  
OFFICER

THE  
DEVELOPER

SUSTAINABLE  
URBAN  
DRAINAGE  
OFFICER

THE  
SURVEYOR

INVESTORS  
OR  
GRANT  
AWARDING  
BODIES

