



WELSH TRADITIONAL BUILDINGS FORUM

FFORWM ADEILADAU TRADDODIADOL CYMRU

Level 3 Award

Energy Efficiency Measures in Older
and Traditional Buildings

Dyfarniad Lefel 3

Mesurau Effeithlonrwydd Ynni ar
gyfer Adeiladau Hŷn a
Thraddodiadol

THE TWO MAIN FUNCTIONS OF MOST BUILDINGS ARE:

To keep the inhabitants dry

To keep the inhabitants warm

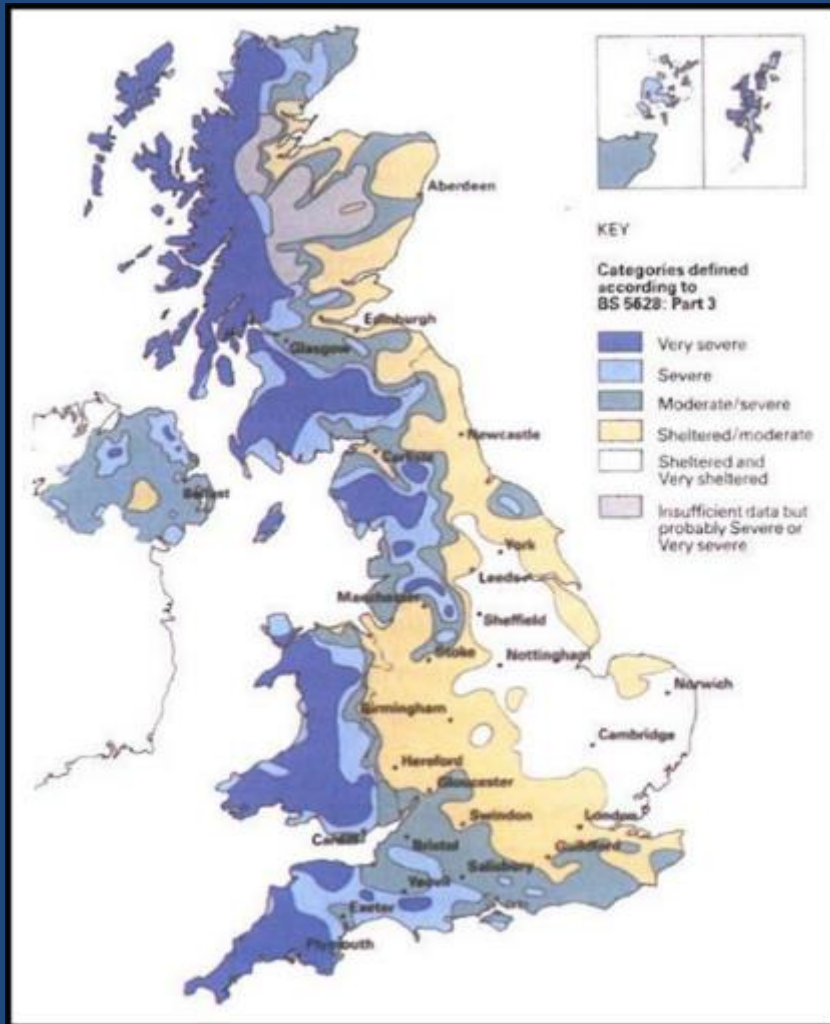

© The Green Building Bible, Vol 2

Figure 1.14. Zones of exposure based on driving rain index. Diagram from GPG95. © Crown Copyright.





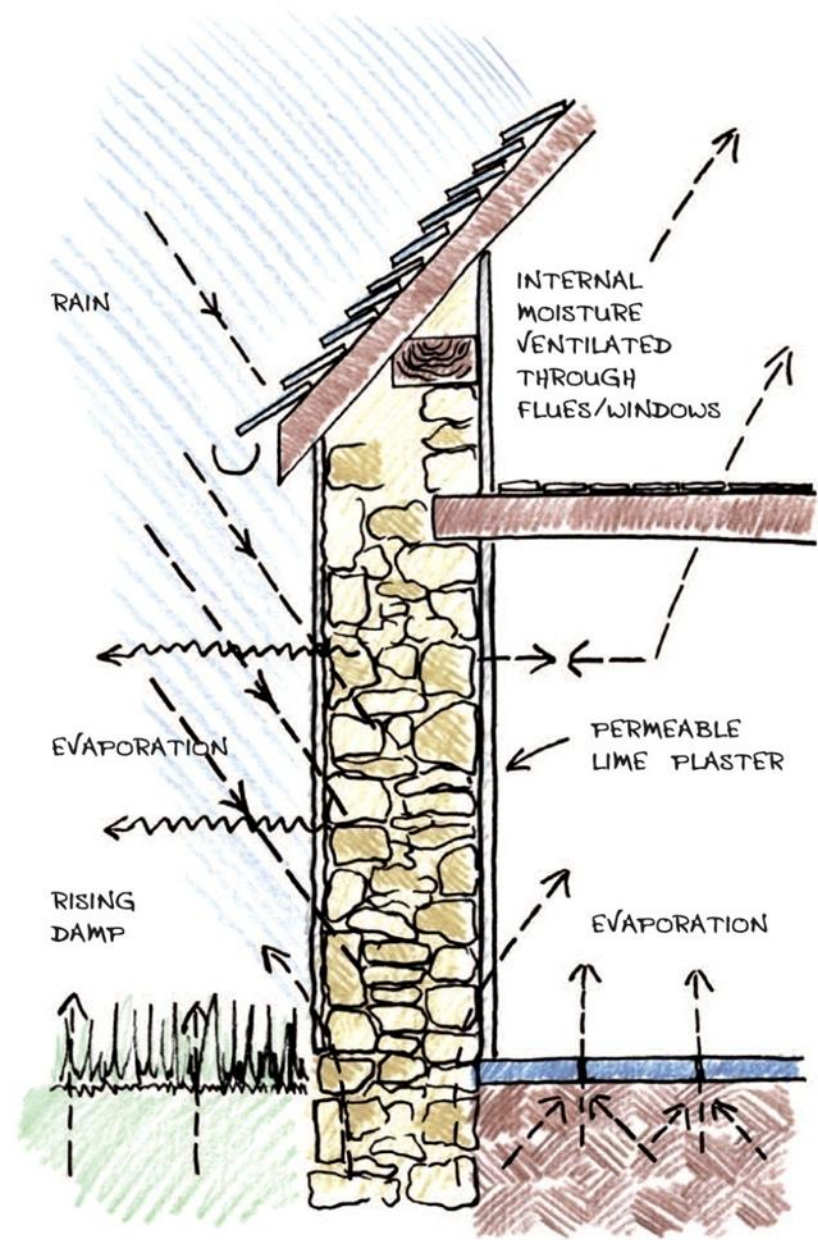

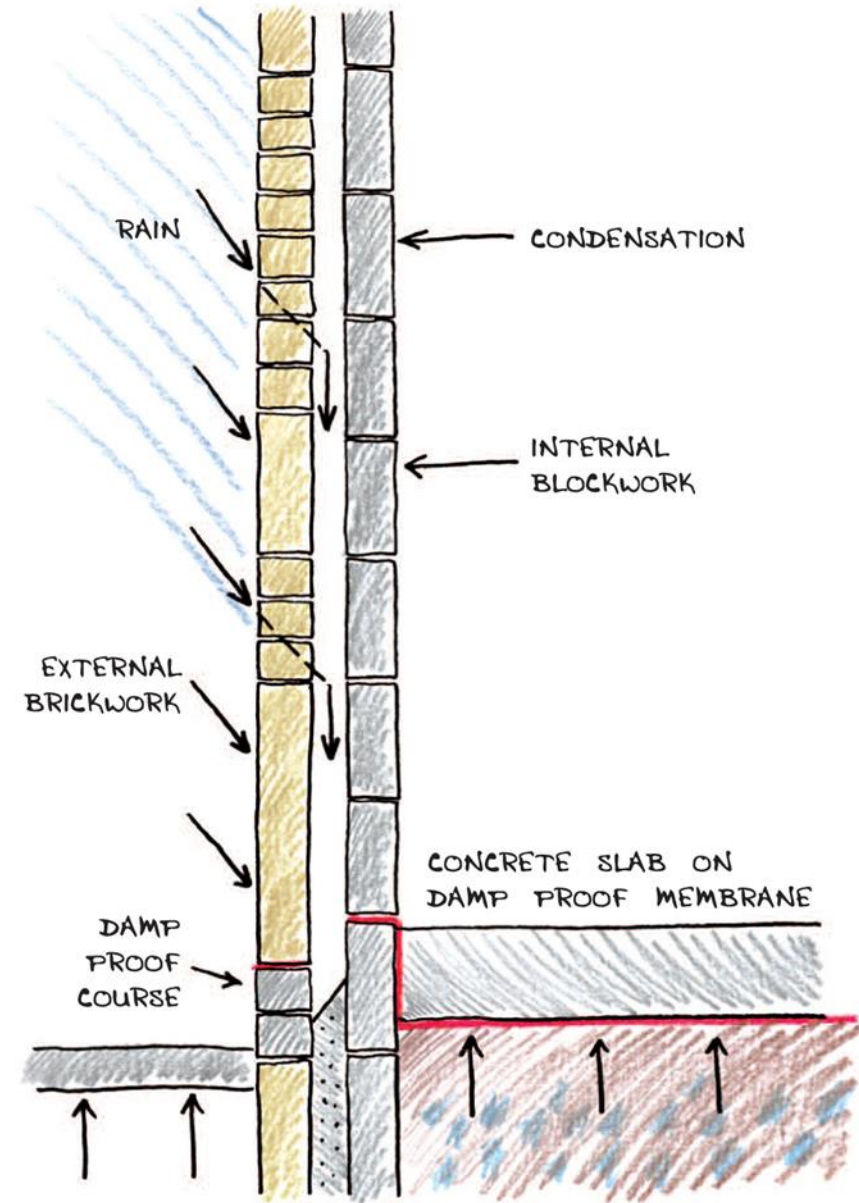
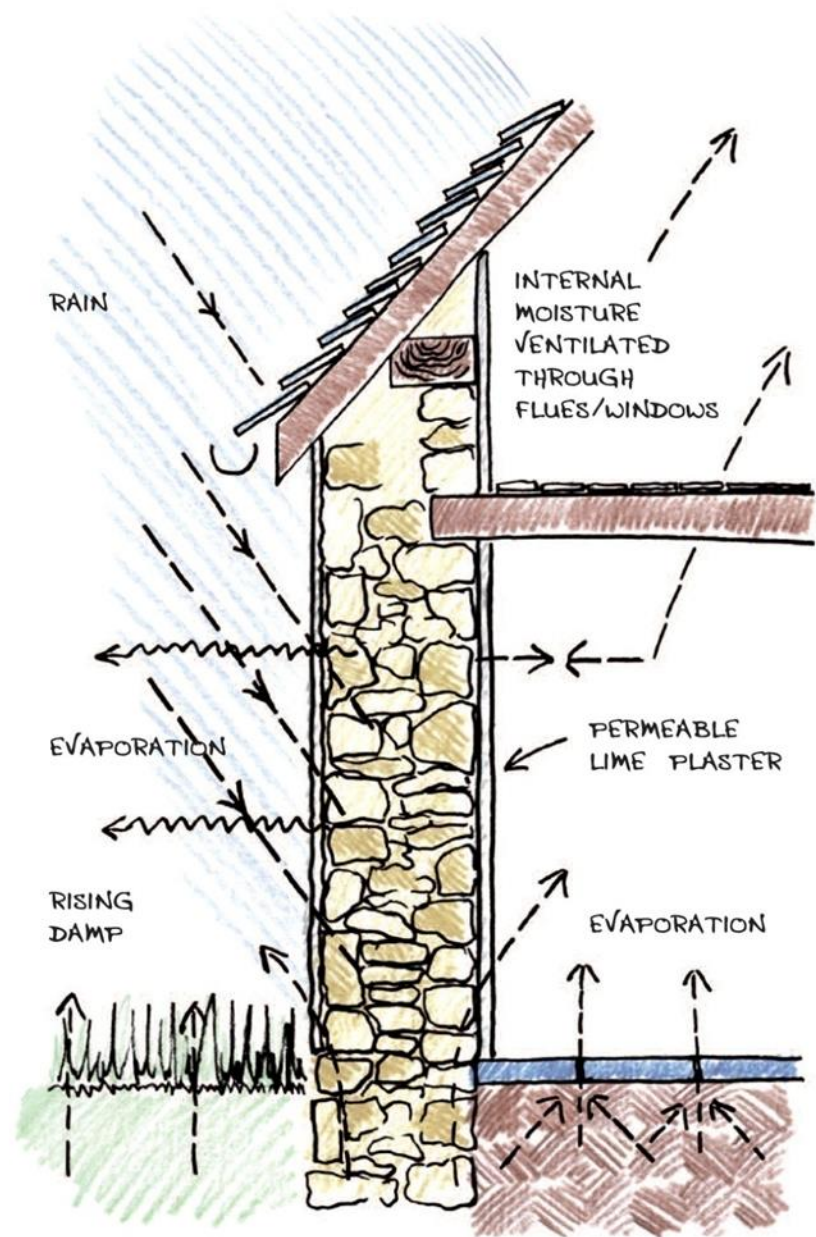



VS



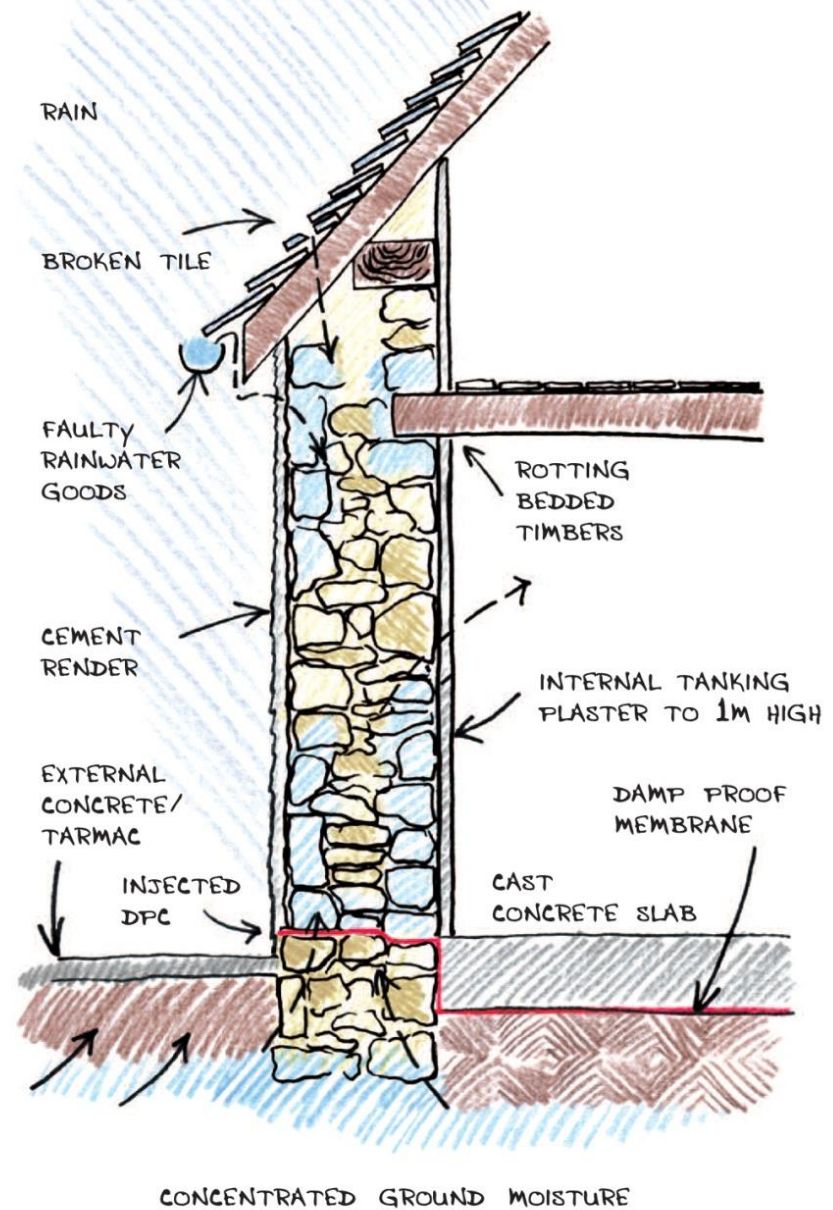
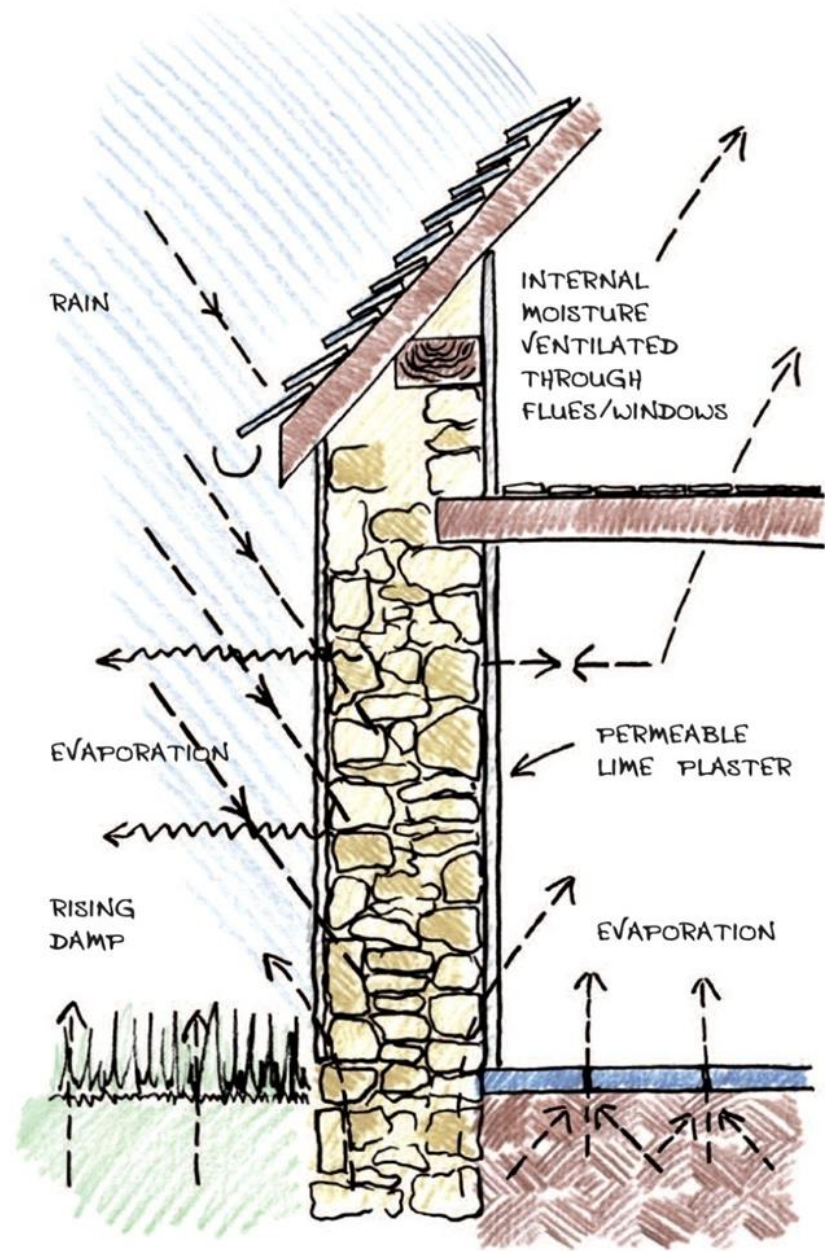





WE DON'T WANT BUILDINGS TO END UP LIKE THIS!